

NPV – Presentation

Our projects in Copenhagen

- NPV A/S
 - Who we are
 - How we work
- Selected projects
 - Enghave Brygge
 - Amager Strand
 - Sydhavnsgade
 - Herlev Bymidte

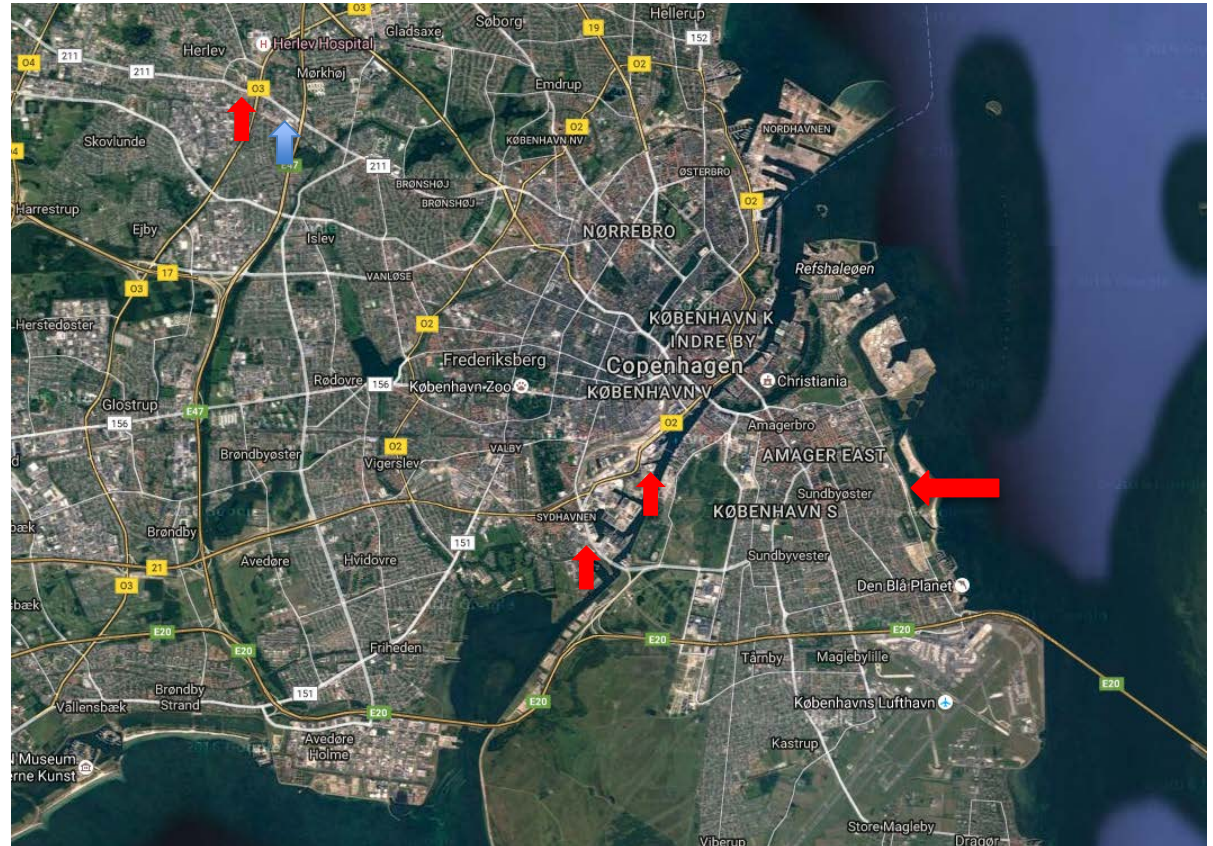

Who we are

NPV was founded in 2010 and is headed by Jens Schaumann and Kim Lautrup; both experienced developer's, domestic as well as abroad.

The Group is private and has an equity base of DKK +150 mill.

The highly skilled staff of NPV works out joint ventures with wealthy partners. The organisation has been working together as a team for many years – also prior to NPV. The track record of the organisation is comprehensive.

NPV primarily work with projects located in Denmark and northern Germany. In northern Germany, our group manages a mixed property portfolio of approx. 258.000 m².

- **Main projects under development:**
- **Amager Strand**
 - 55.000 m²
- **Enghave Brygge**
 - 160.000 m²
- **Sydhavnsgade**
 - 95.000 m²
- **Herlev Bymidte**
 - 58.000 m²
- **Gammelhavn Vejle**
 - 90.000 m²

Our Projects at Enghave Brygge



- We develop 120.000 m² residential and 40.000 m² commercial properties in the harbor with very close proximity to the city center.
- Two metro station will come.
- Six artificial islands constructed 2016-2020.
- Total area volume approx. 292.000 m².



Visit the website www.engholmene.dk

Follow the development at <http://engholmene.roundshot.com/>

Enghave Brygge – sales

Myrholm

39

SOLGT

11

RESERVERET

60

LEDIG

Kærholm

112

SOLGT

3

RESERVERET

77

LEDIG

Samlet på Engholmene

151

SOLGT

14

RESERVERET

137

LEDIG

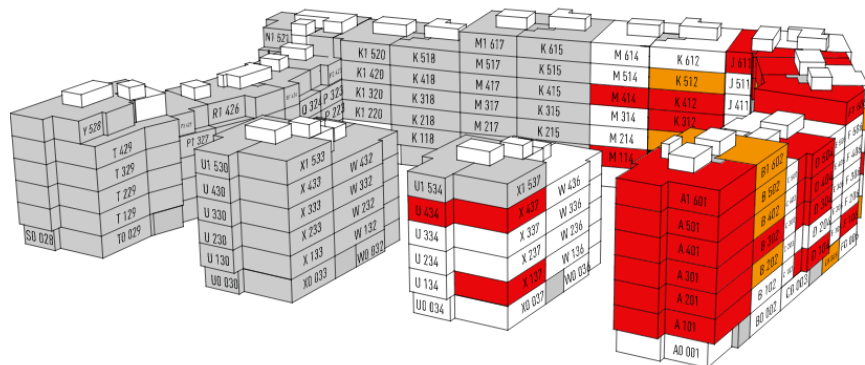
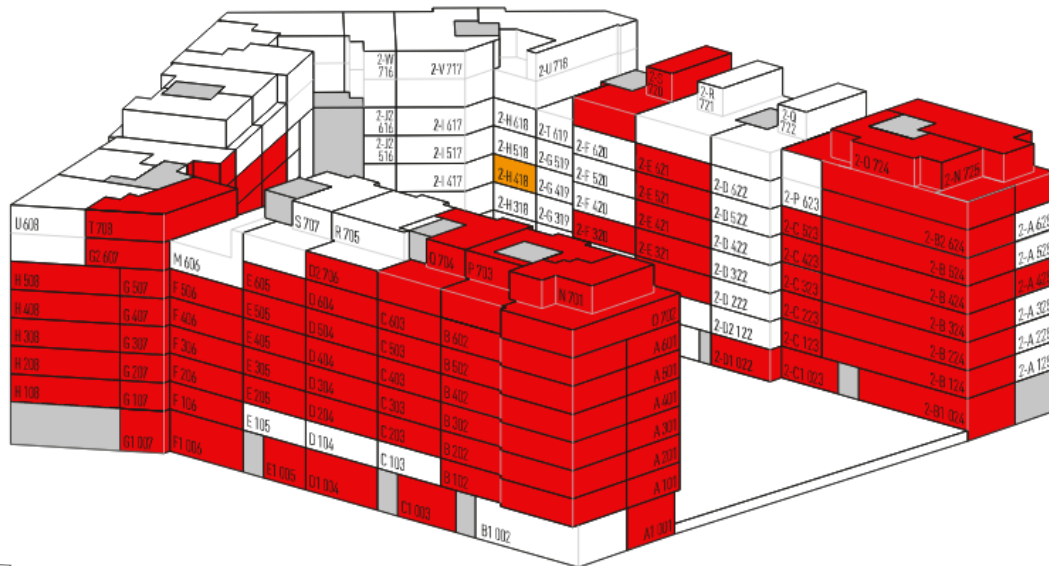

- Kærholm completion 1.2.2017-1.12.2017
- Myrholm completion 1.7.2018-31.3.2019

Our Projects at Amager Strand

Amager Strand prior to development



>> Aerial photo March 2016.



- Development of approx. 55.000 m² (out of 130.000 m²) mainly residential properties in cooperation with ELF Development.
- Acquired in 2010. +80% completed.
- Status – awaiting local plan to enable final tower, row houses and the completion of commercial (old industrials renovation).

Our Project at Sydhavnsgade

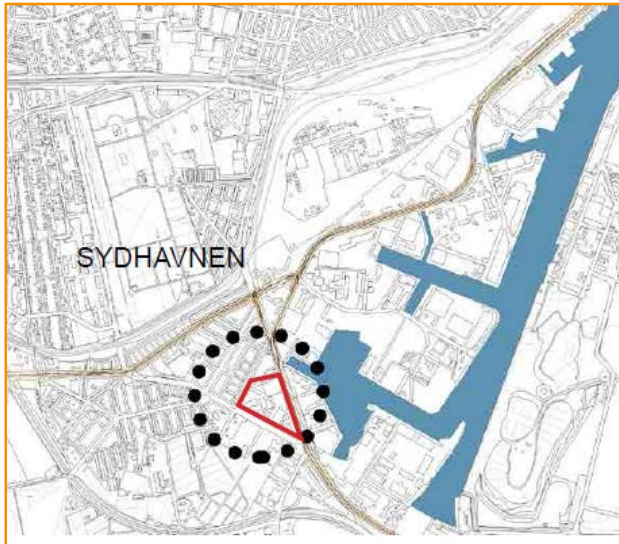

- 95.000 m² residential, office, school and retail development at the main ring road leading to the city.
- Local plan workout to commence officially in Q4 2016.
- Expecting local plan before year end 2017.



Our Project at Herlev Bymidte

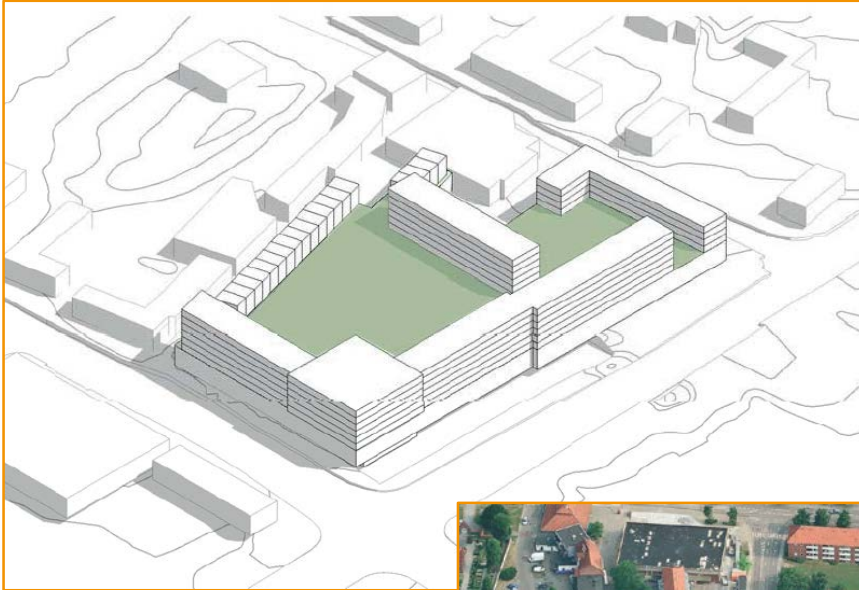

- **58.000 m² development at the city center of Herlev**
 - 20.000 m² retail
 - 8.000 m² office
 - 30.000 m² residential
- **Local plan workout in process**
- **Expecting local plan before year end 2017.**
- **In cooperation with NREP**
- **NPV and NREP has successfully developed and delivered the shopping center BIG of 45.000 m² to a new end investor in the spring 2016.**

Contact



Jens Schaumann
Kim Lautrup

NPV A/S
Jægersborg Alle 1A
2920 Charlottenlund
Telefon: + 45 70 21 01 13
Web: www.npv.as